



www.MLMEBLE.pl

GB D CZ SK RUS LT  
assembly instructions / montageanleitung / montážní návod / montážny návod / инструкции по монтажу / surinkimo instrukcija



# INSTRUKCJA MONTAŻU

## PIK 02P N

↑66 →90 ↗30

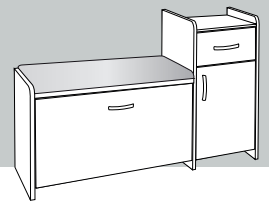



akcesoria / accessories / zubehör / příslušenství / príslušenstvo / аксессуары / furnitūra :

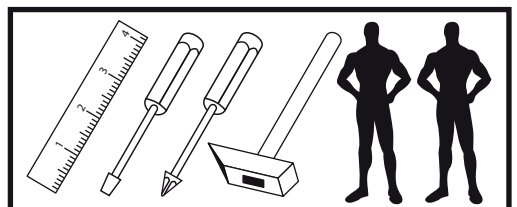

x 18  KK 8/30	x 14  KT 7/60	x 6  SG 8/8	x 1  kluczyk / key / schlüssel / klíč / ključ / ключ / raktas	x 40  GZ 1/10	x 1  klej / glue / kleber / lepido / lepidlo / клей / kljaj	x 16  WT 3,5x16	x 4  WE 6,3x13
x 2  ZA 3R-11	x 2  TA 3R-11 Ø14	x 2  TA 3R-11 Ø20	x 2  OK 3R-11	x 10  ZAK	x 2  MB	x 6  WT 4x35	x 3  UT L96
x 2  PK H-4	x 2  ZPW	x 2  MD	x 1  PA L250	x 4  PA Ø5	x 16  WT 3x16	x 8  WE 6,3x16	x 4  BDP

do montażu potrzebne są:

are needed for assembly:  
sind erforderlich für die montage:  
jsou potřebné pro montáž:  
sú potrebné pre montáž:  
которые необходимы для сборки:  
Surinkimui reikės

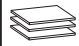

	CODE			
1	PIK02NP_01	450	296	1
2	PIK02NP_02	648	296	1
3	PIK02NP_03	648	296	1
4	PIK02NP_04	582	294	1
5	PIK02NP_05	582	192	1
6	PIK02NP_06	578	356	1
7	PIK02NP_07	264	294	1
8	PIK02NP_08	264	276	1
9	PIK02NP_09	259	140	1
10	PIK02NP_10	413	259	1
11	PIK02NP_11	207	92	1
12	PIK02NP_12	250	92	2
13	PIK02NP_13	263	262	1
14	PIK02NL_14	569	140	4
15	PIK02NHDF_01	602	209	2

	CODE			
16	PIK02NHDF_02	573	288	1
17	PIK02HDF_03	237	255	1
18	SIEDZISKO	582	294	1

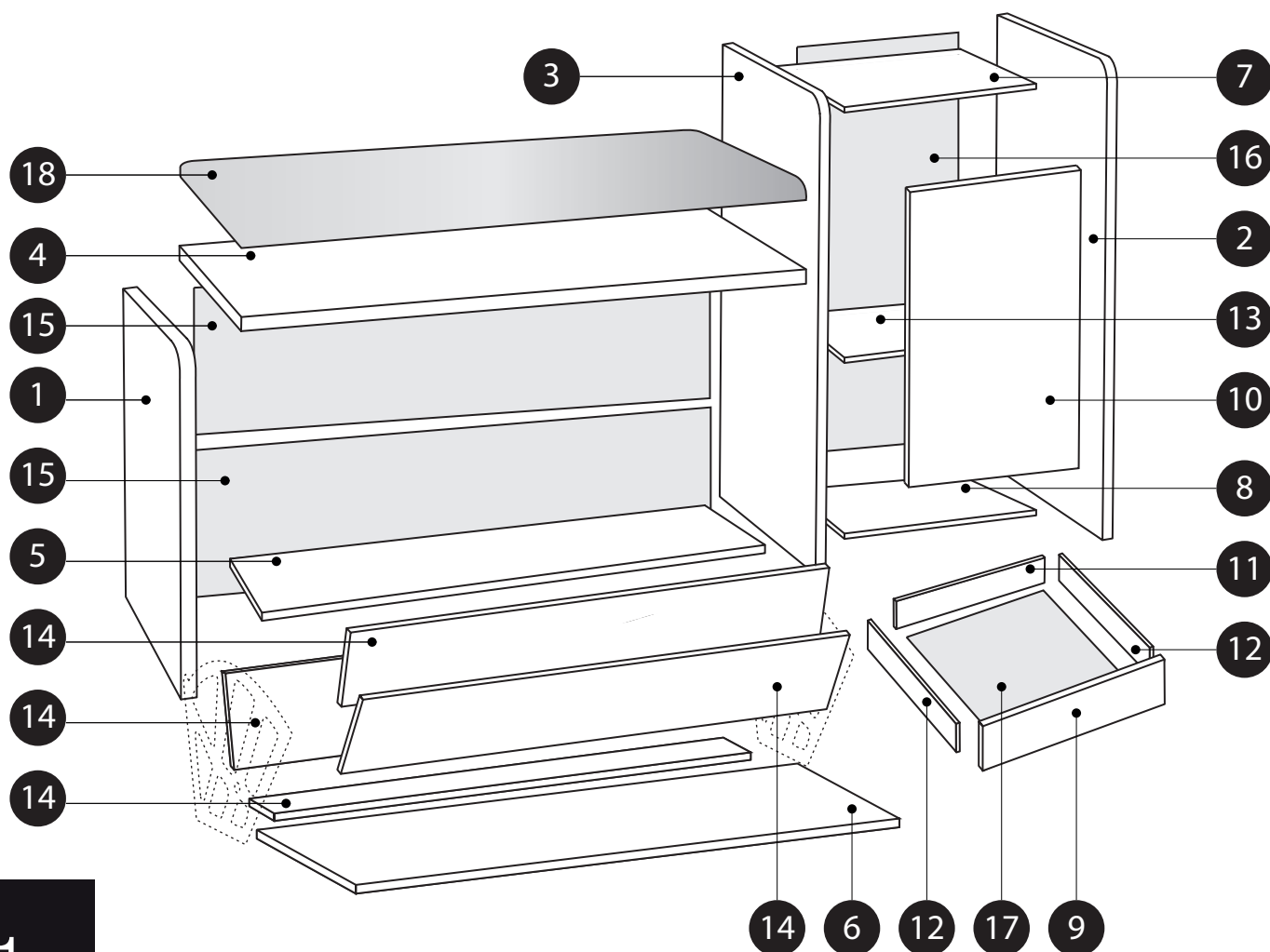
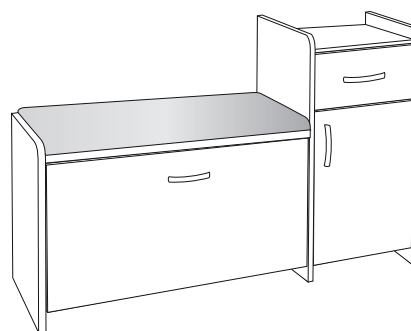

**!**  
**UWAGA!** - w pierwszej kolejności wbijamy akcesoria „KK” i „MD” w białe otwory.  
**WARNING!** - The first accessory sticks “KK” and “MD” in the tops and sides.  
**WARNUNG!** - Die erste Accessoire-Sticks “KK” und “MD” in den Spitzen und an den Seiten.  
**POZOR!** - První příslušenství holi “KK” a “MD” v korunnách a boky.  
**POZOR!** - Prvé príslušenstvo palis “KK” a “MD” v korunnách a boky.  
**ВНИМАНИЕ!** - Первый аксессуаров палочки “KK” и “MD” по верхинам и по бокам.  
**DĚMESIO!** - Pirmaisiai furnitūra KK ir MD įkalame į statyviršij ir šonus.

