

82271

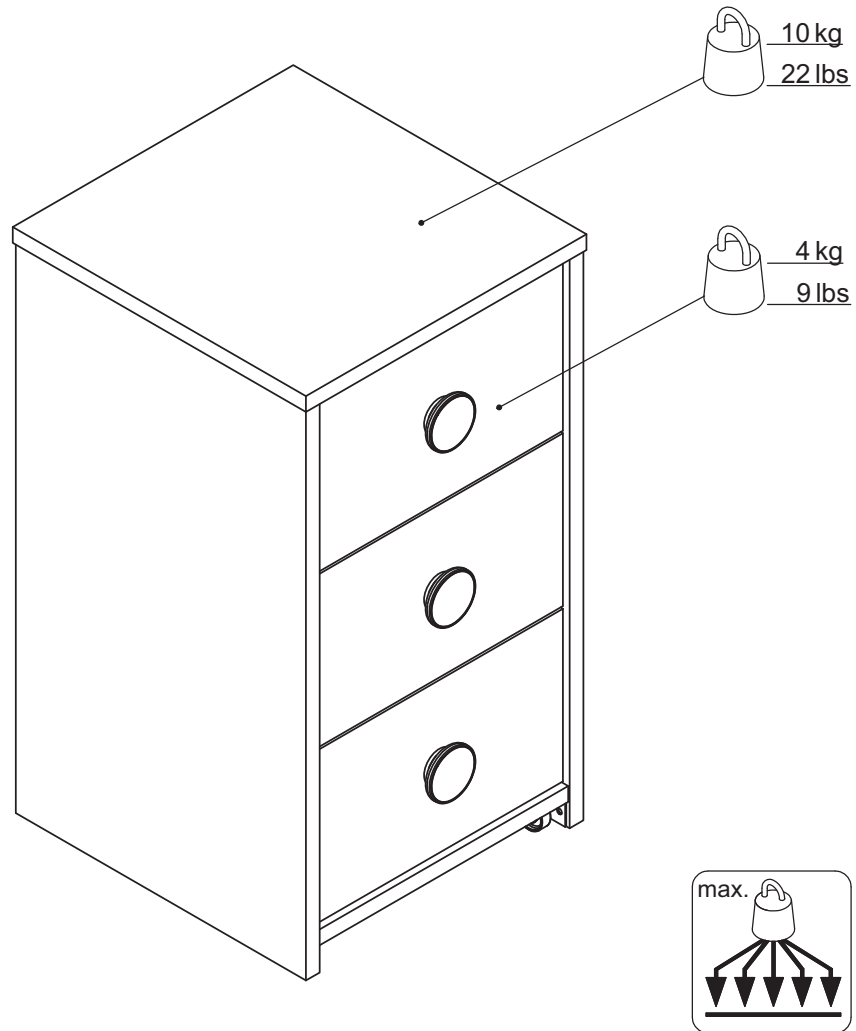

www.tvilum.com

 **CERTIFIED CARE**
Produced with respect for nature and people



tvilum
living your way

82271-50 A

10872

x3

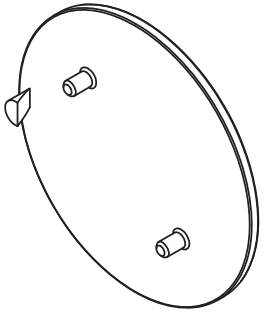

20203

x12



20228

x12

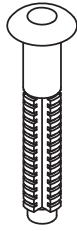

22601

x1

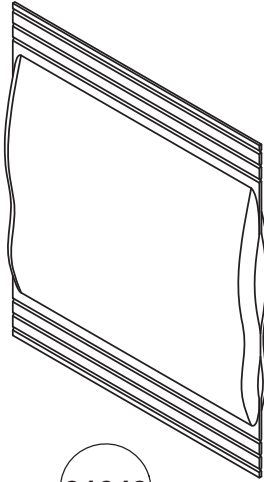

25506

x6

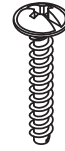

26020

x12



41404

x6

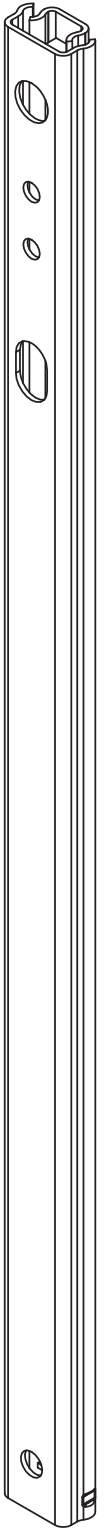

26040

x8



26214

x6



31513

x14

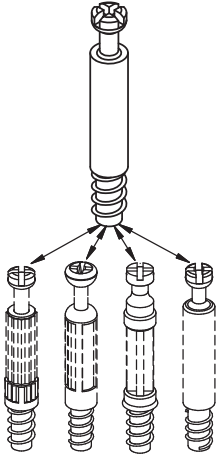

31631

x6



31643

x8



63403

x4

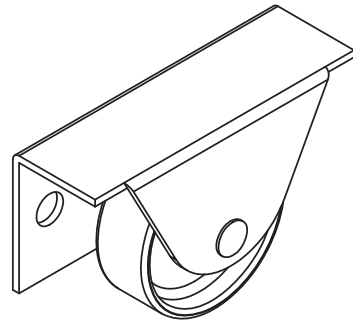

80102

x9

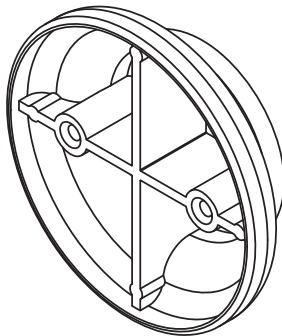

88042

x1

WARNING

Serious or fatal crushing injuries can occur from furniture tip over. To help prevent tip-over:

- Place heaviest items in the lowest drawers
- Do not set TV's or other heavy objects on the top of the product
- Never allow children to climb or hang on drawers, doors or shelves
- Never open more than one drawer at a time

Use of tip-over restraints may only reduce but not eliminate the risk of tip over.

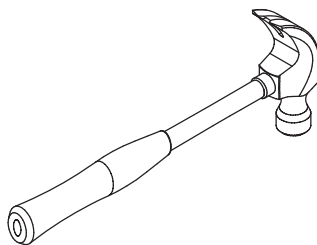
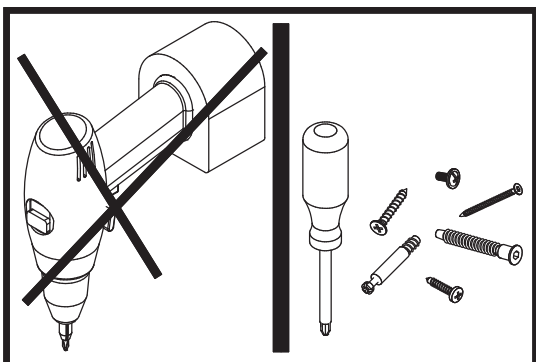

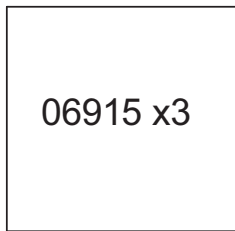
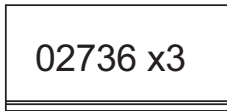
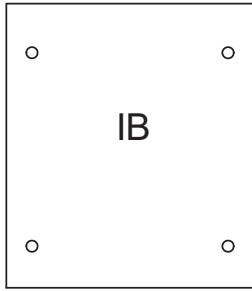
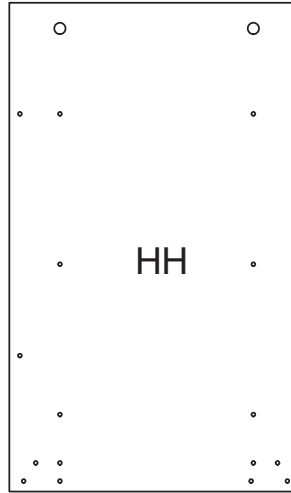
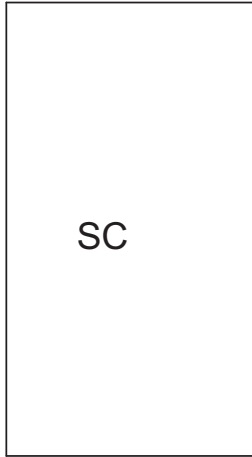
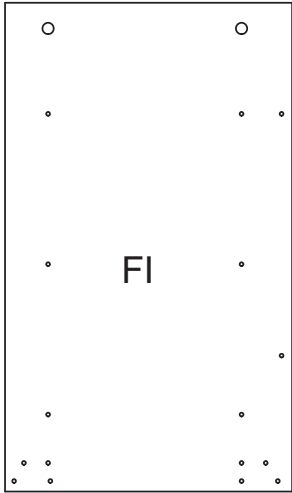

1

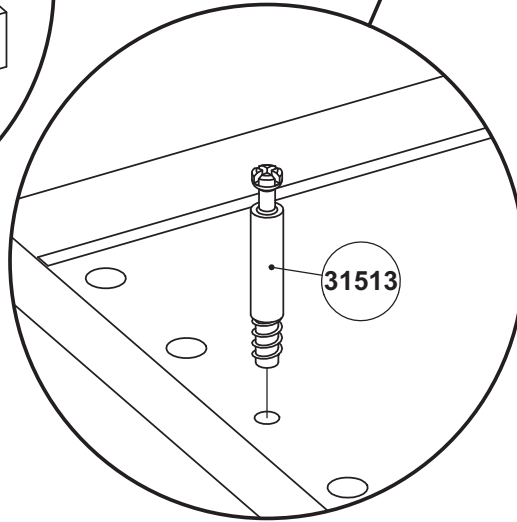
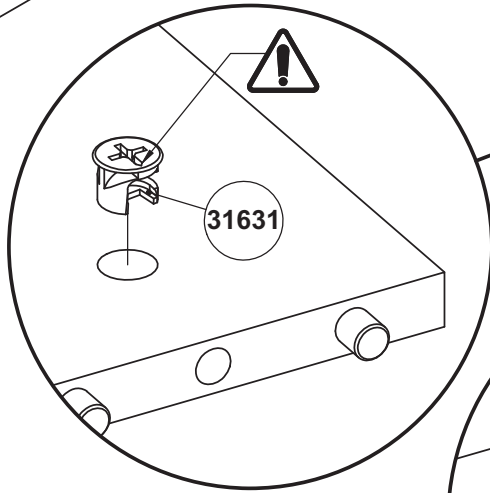
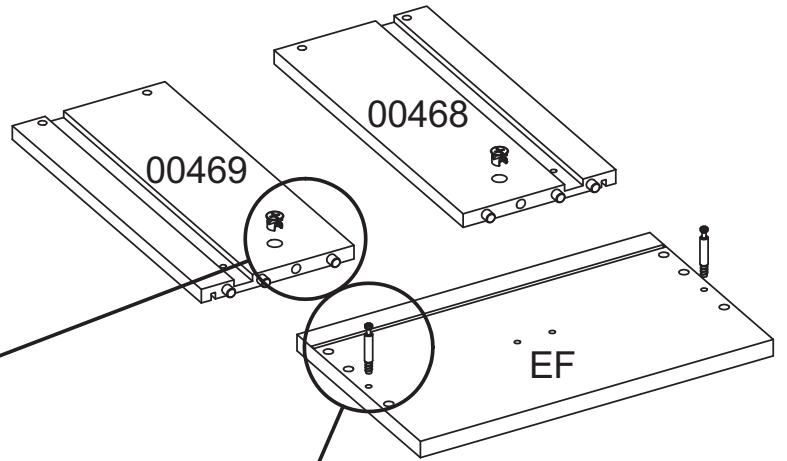
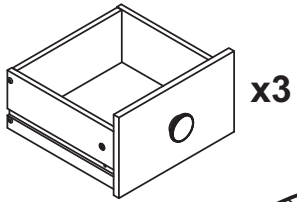

2

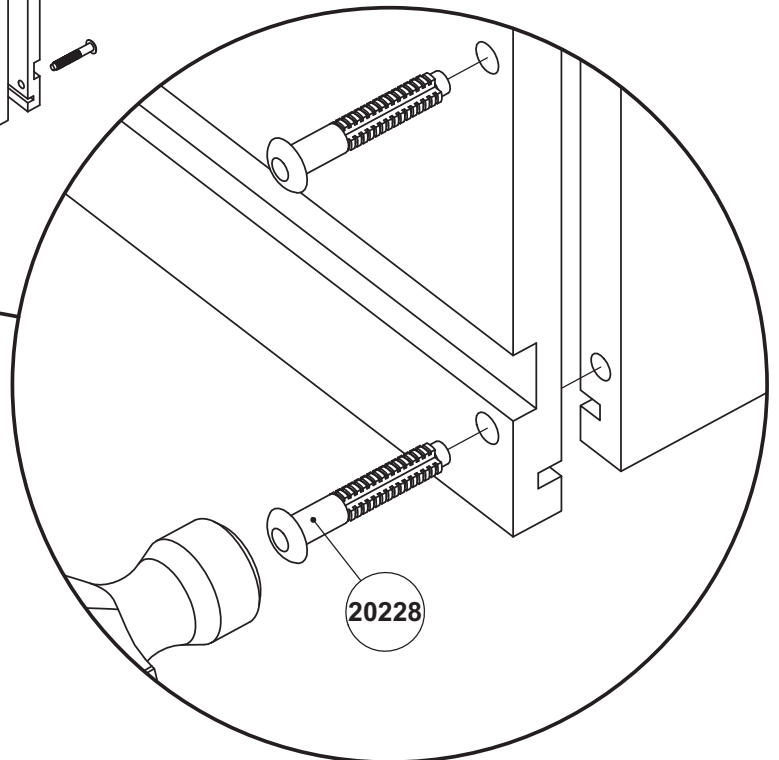
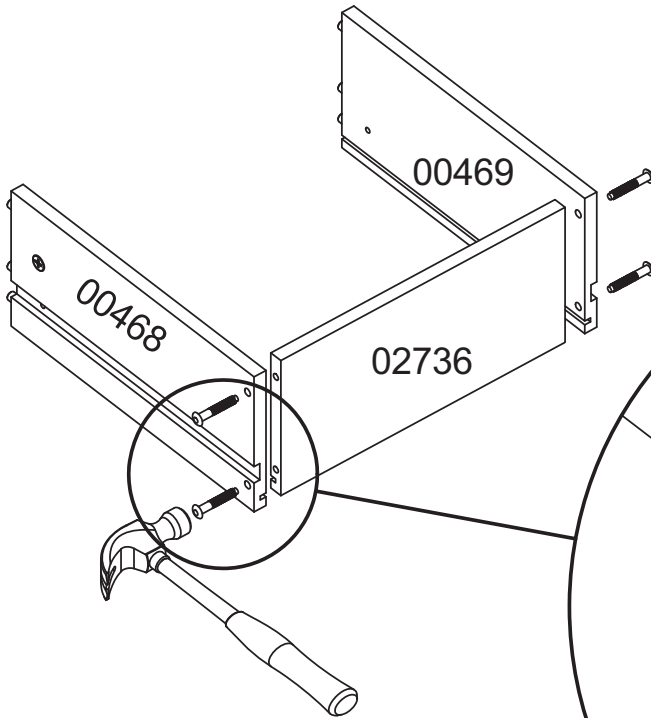

3

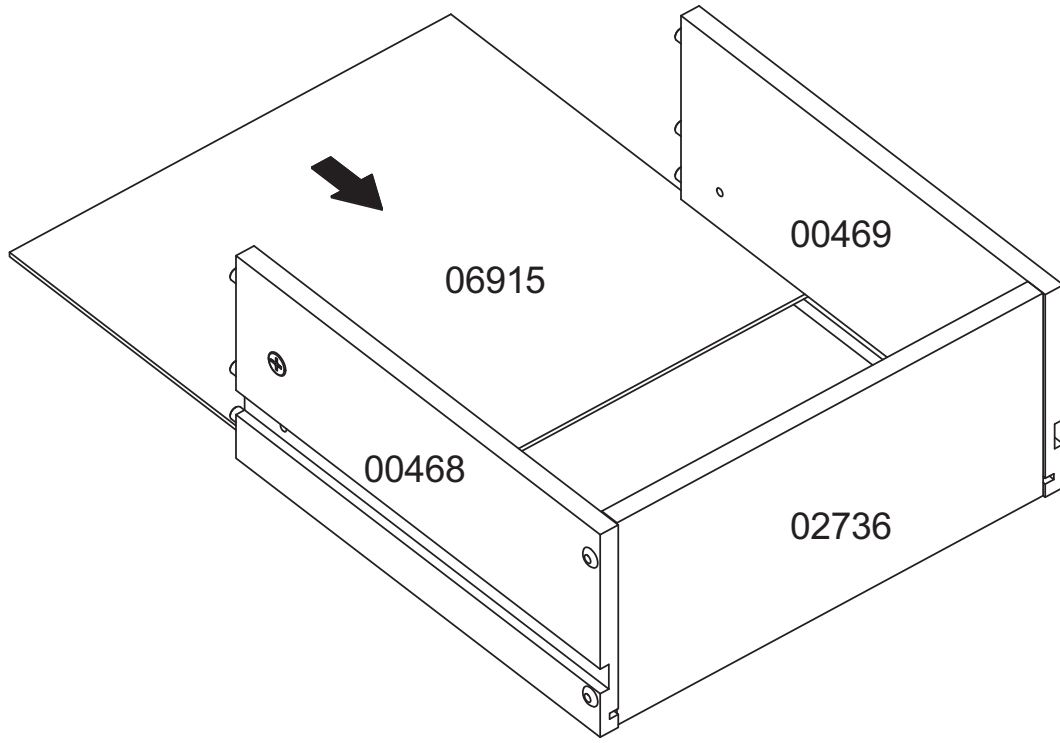

4

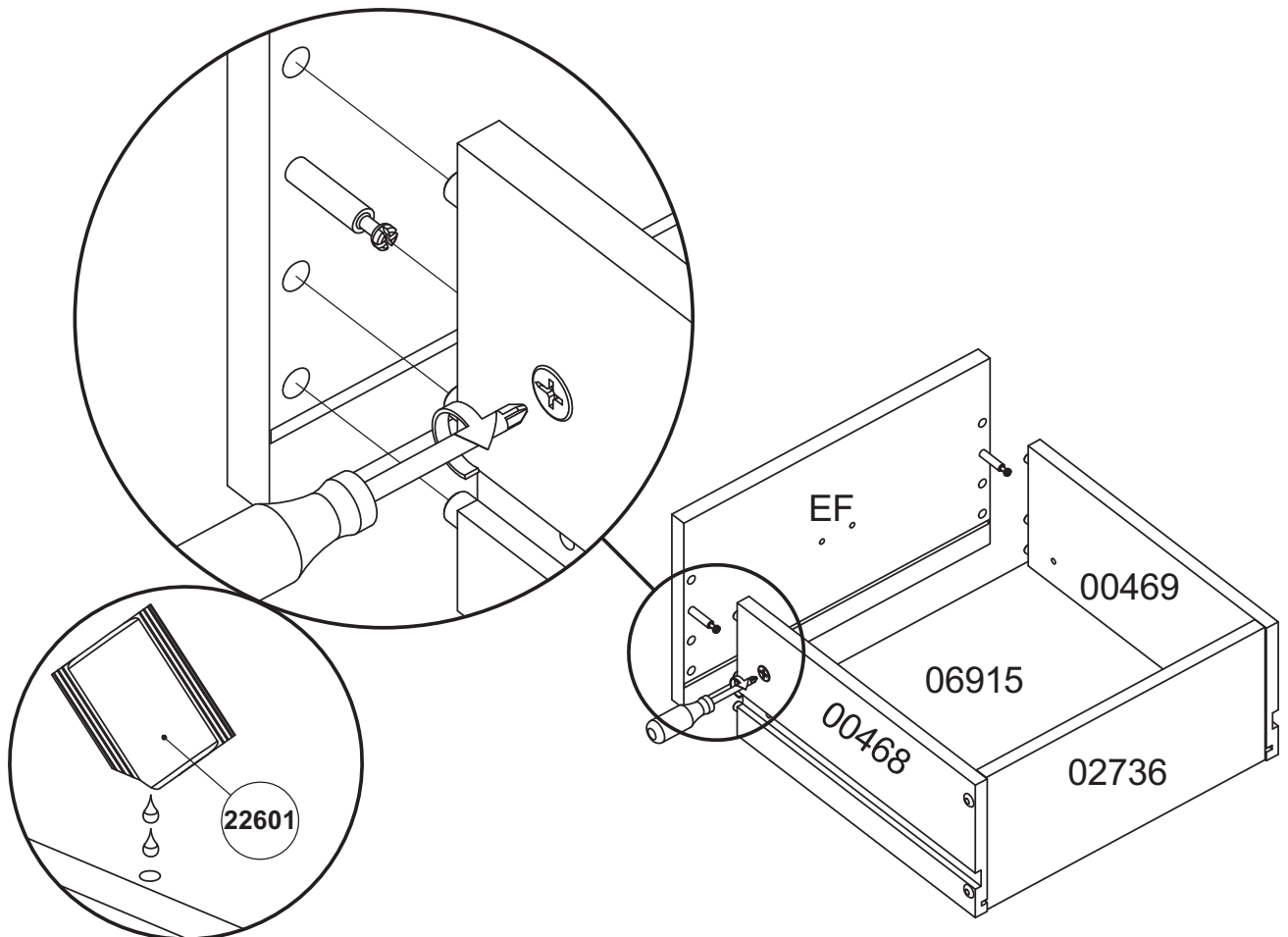

5

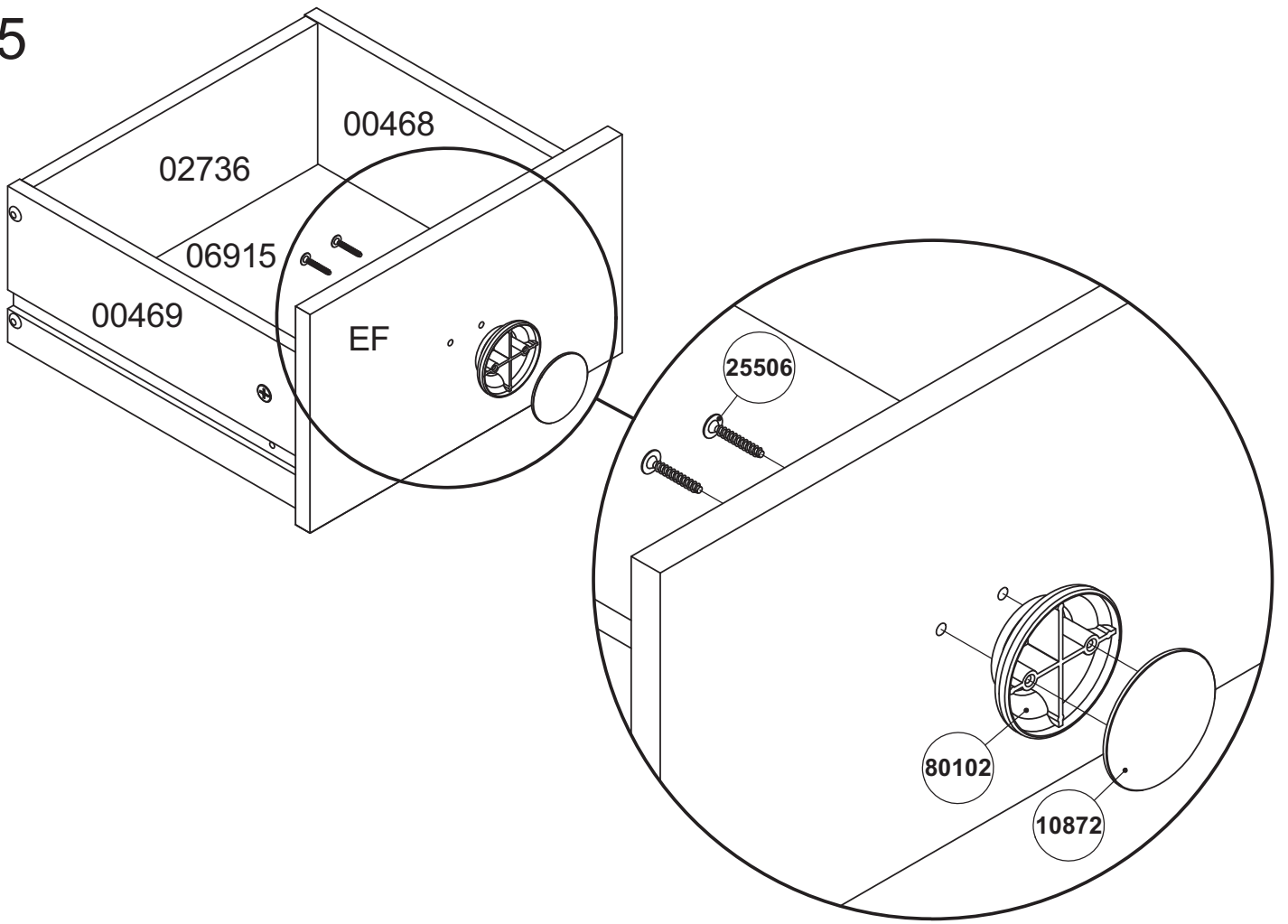

6

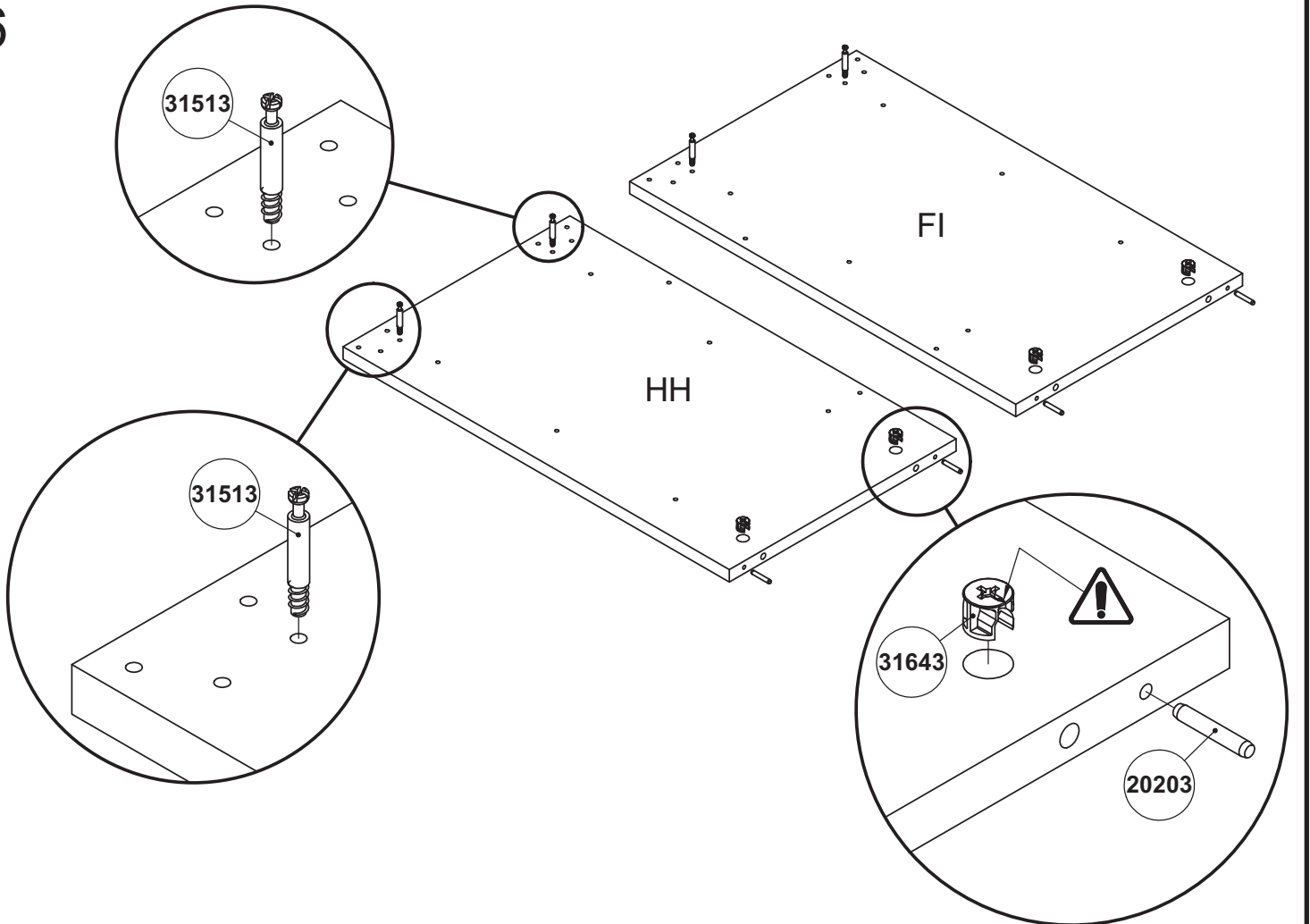

7

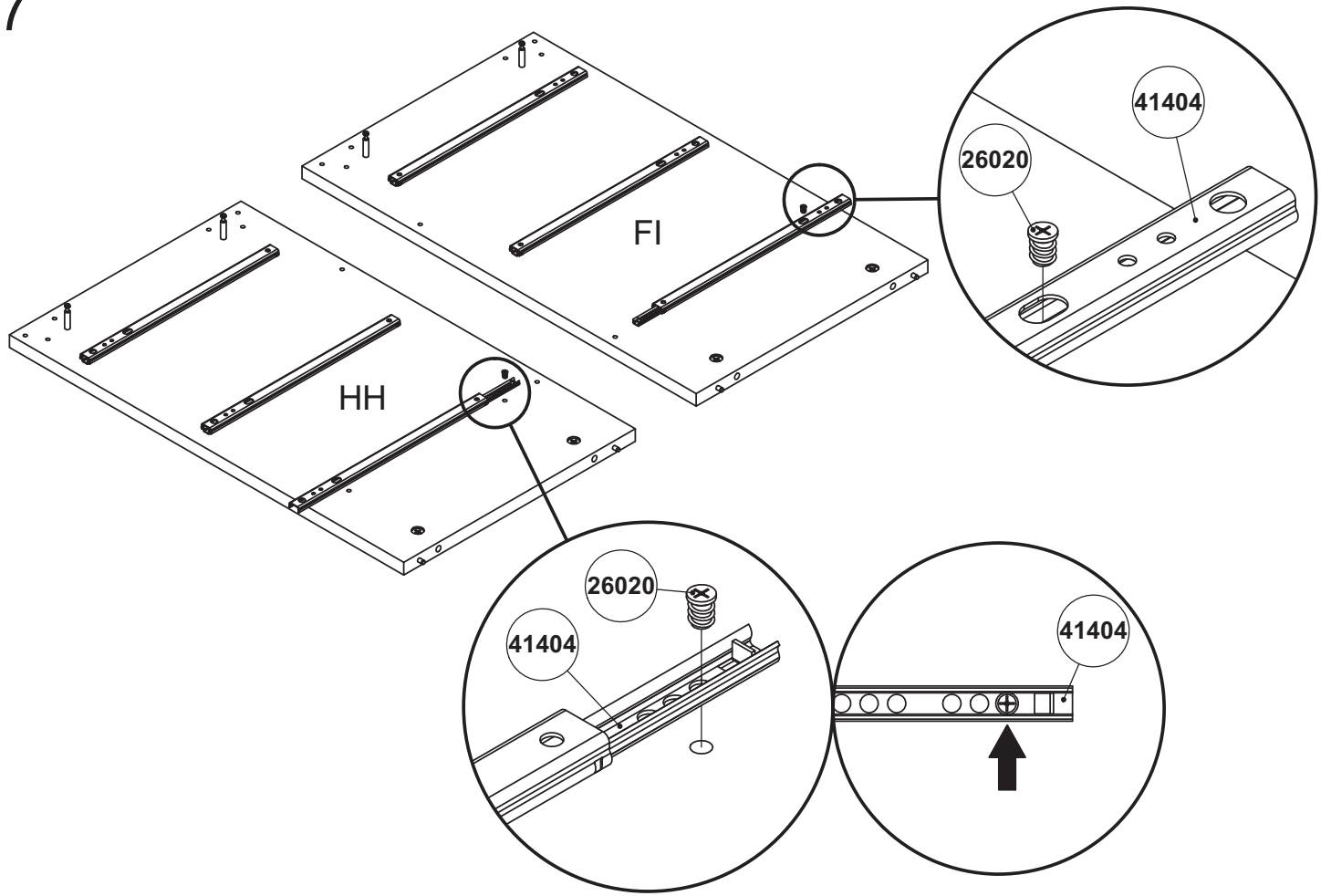

8

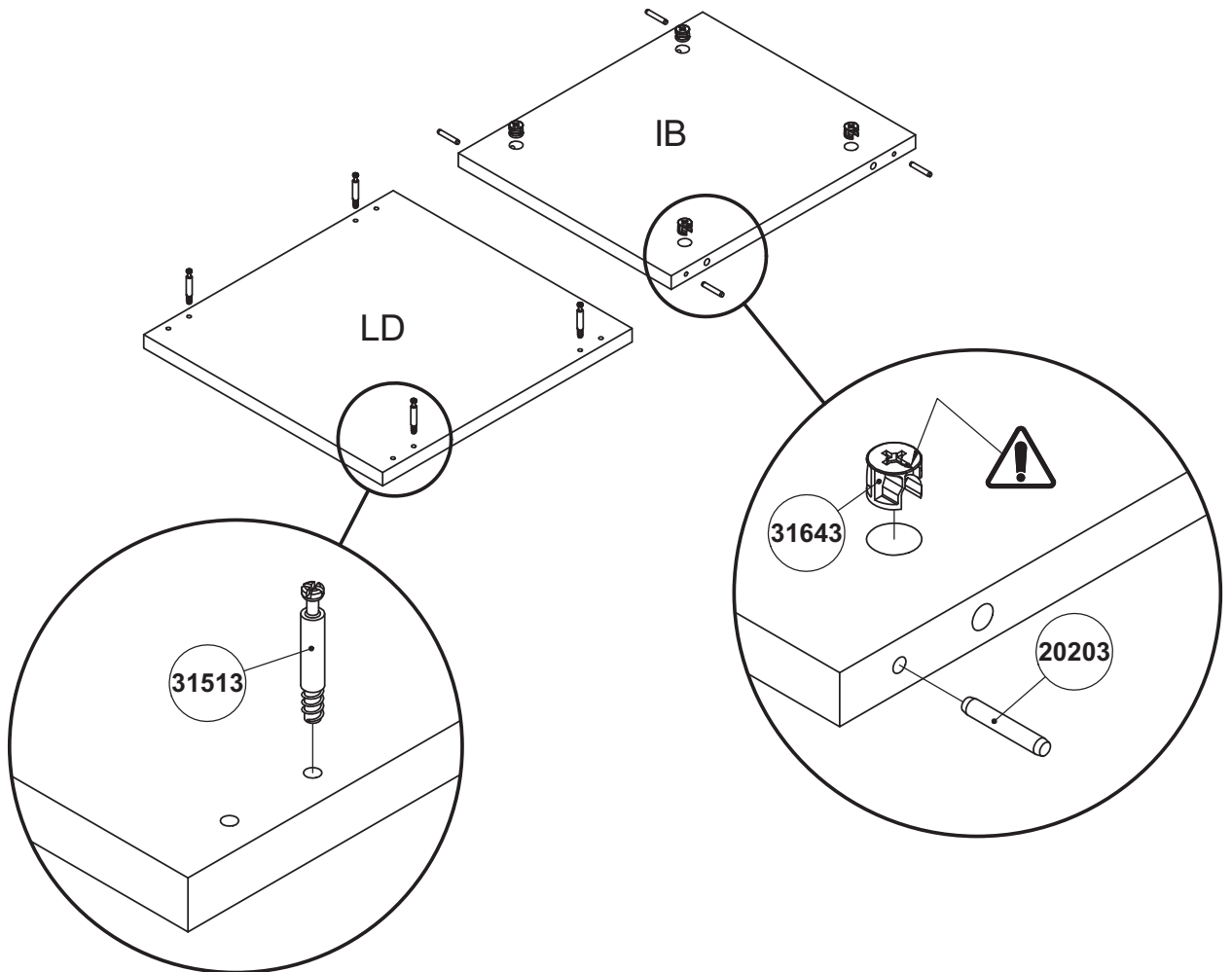

9

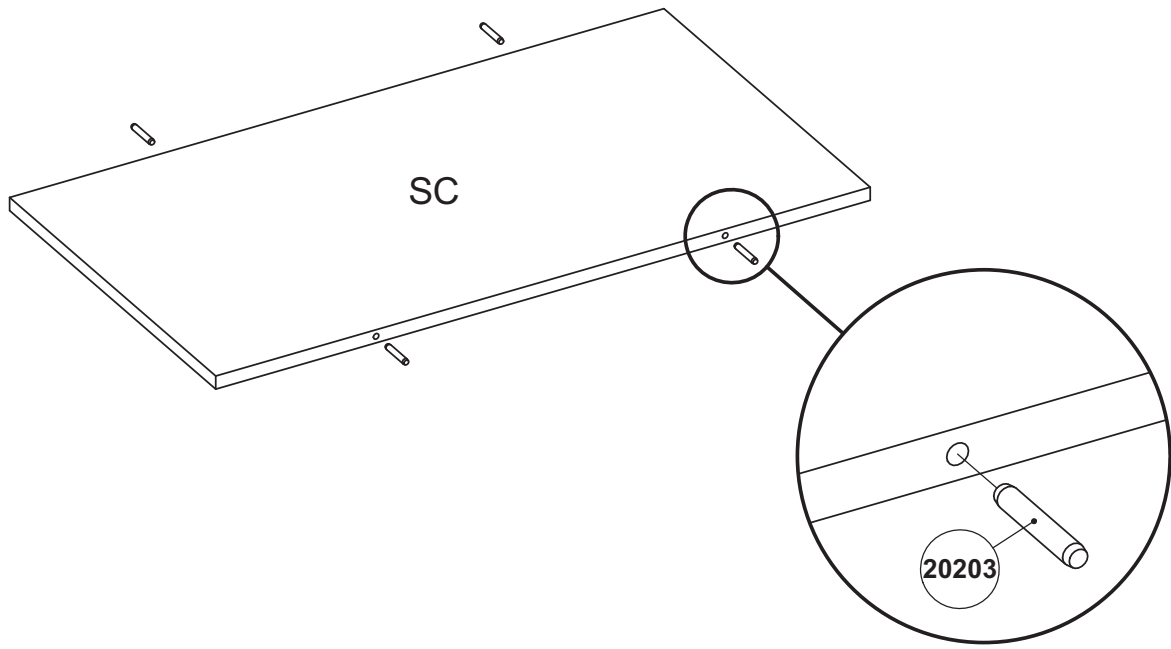

10

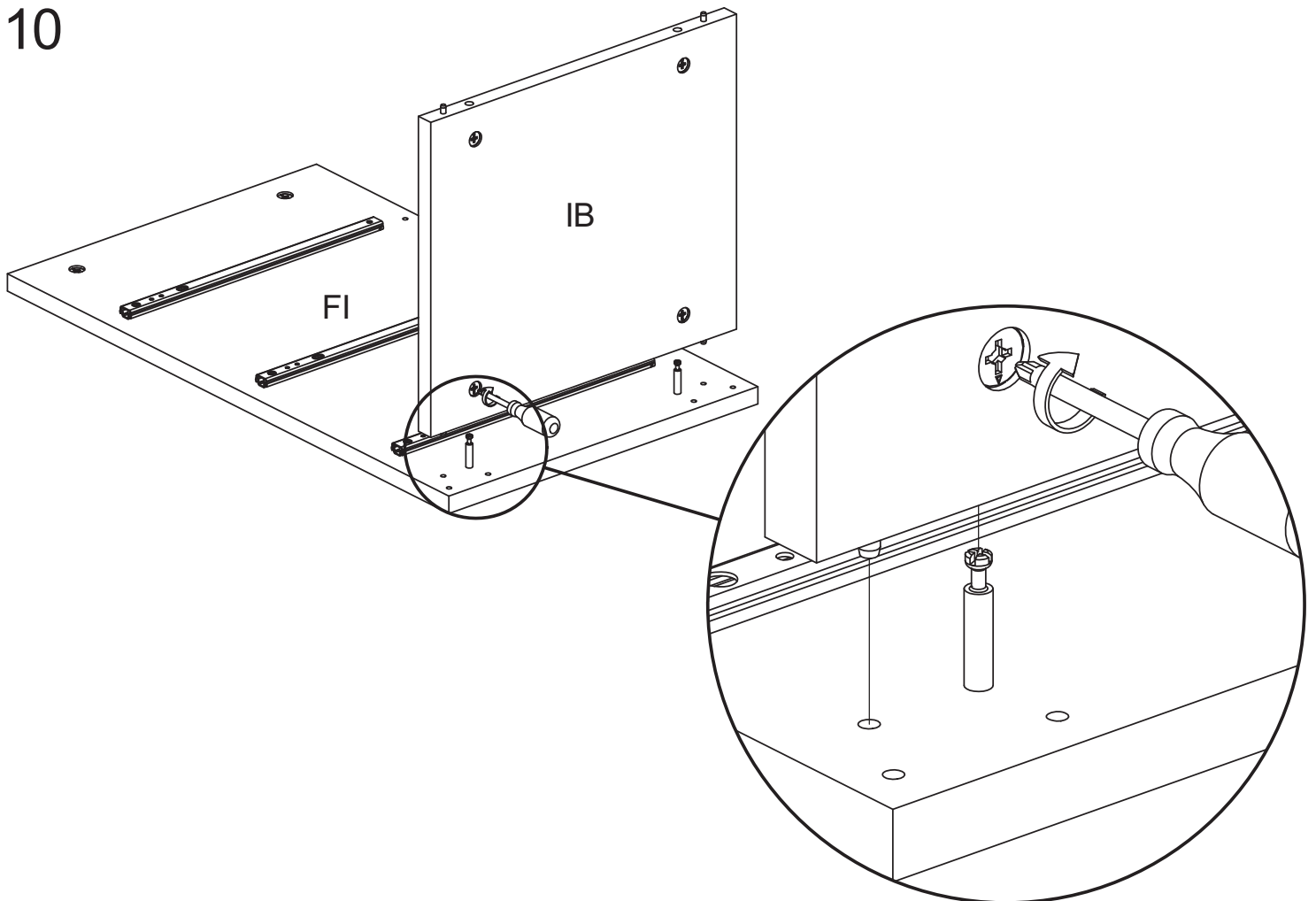

11

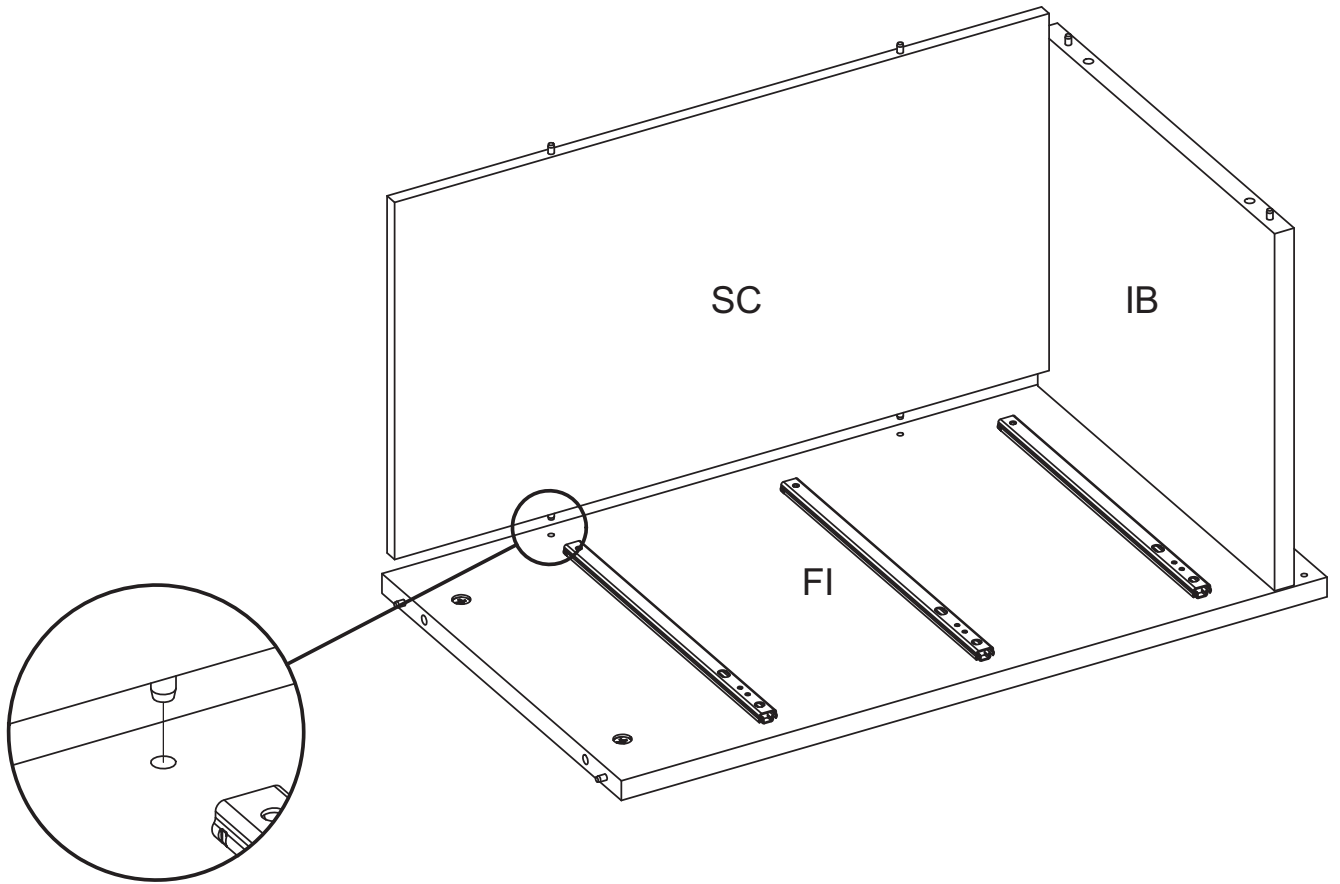

12

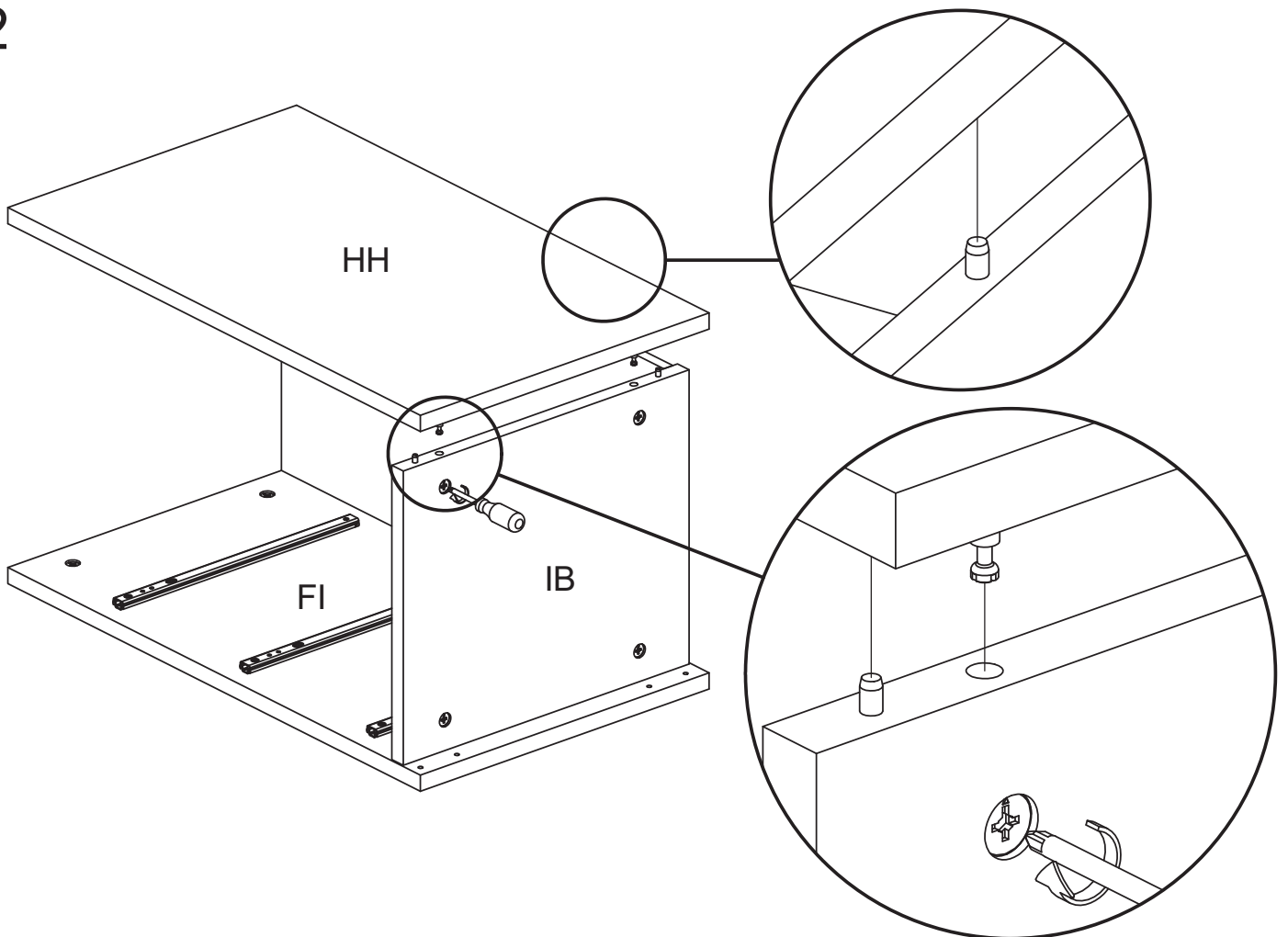

13

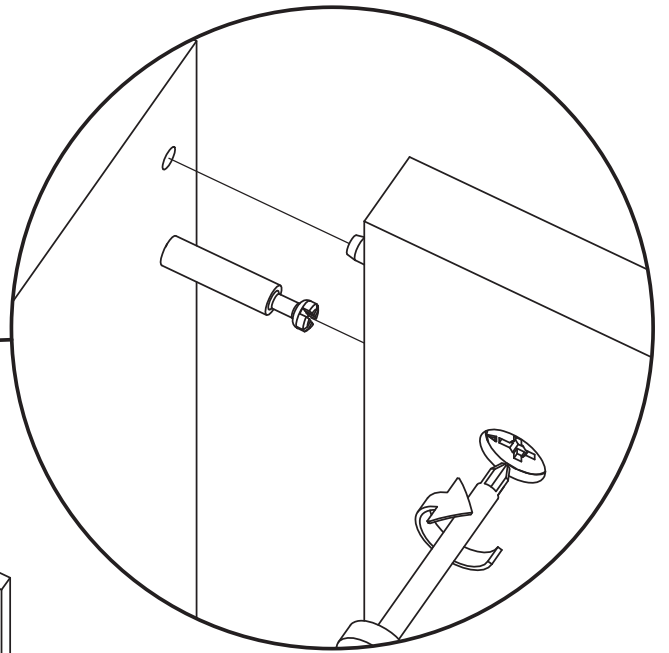
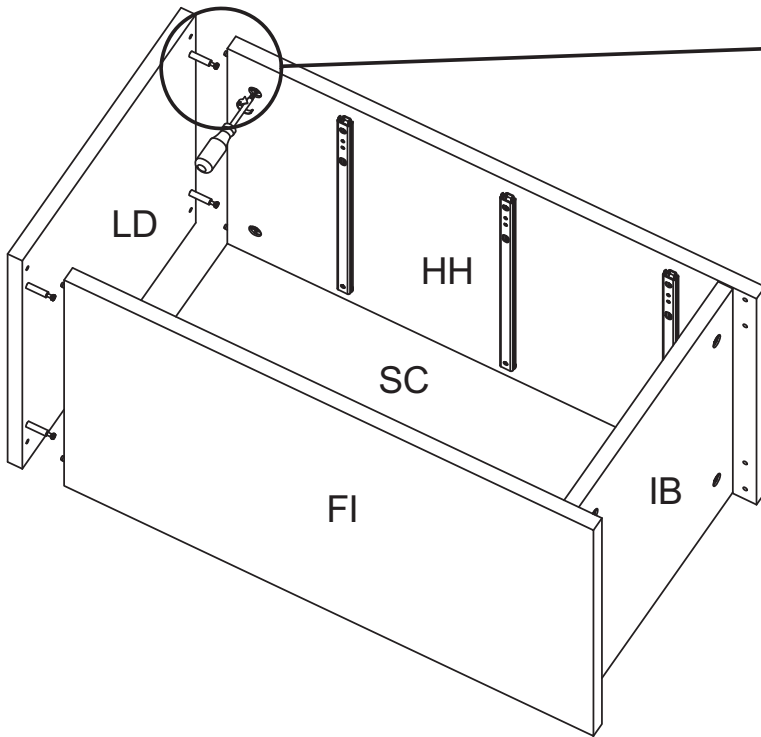

14

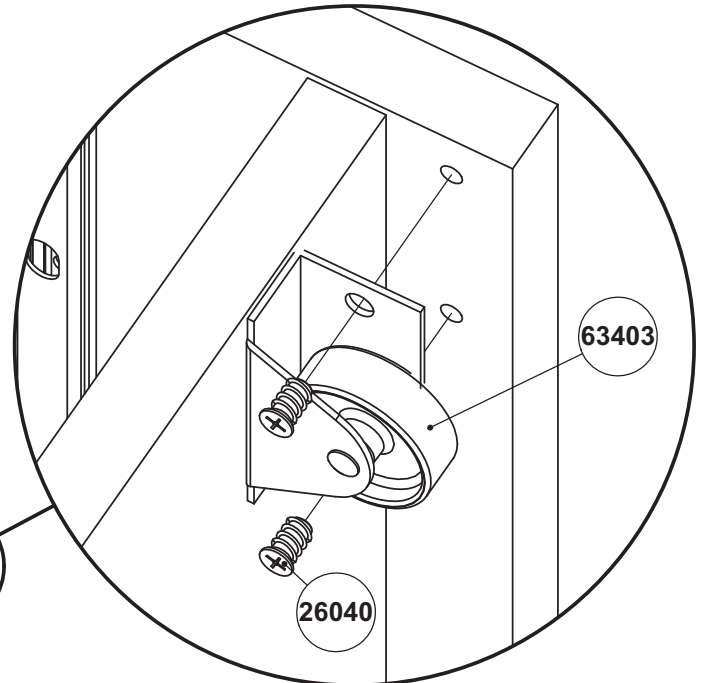
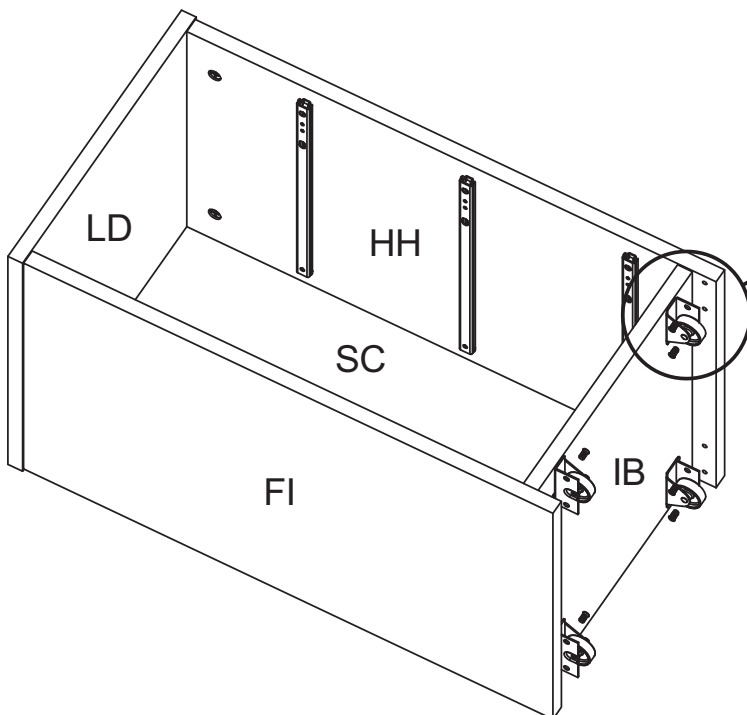

15

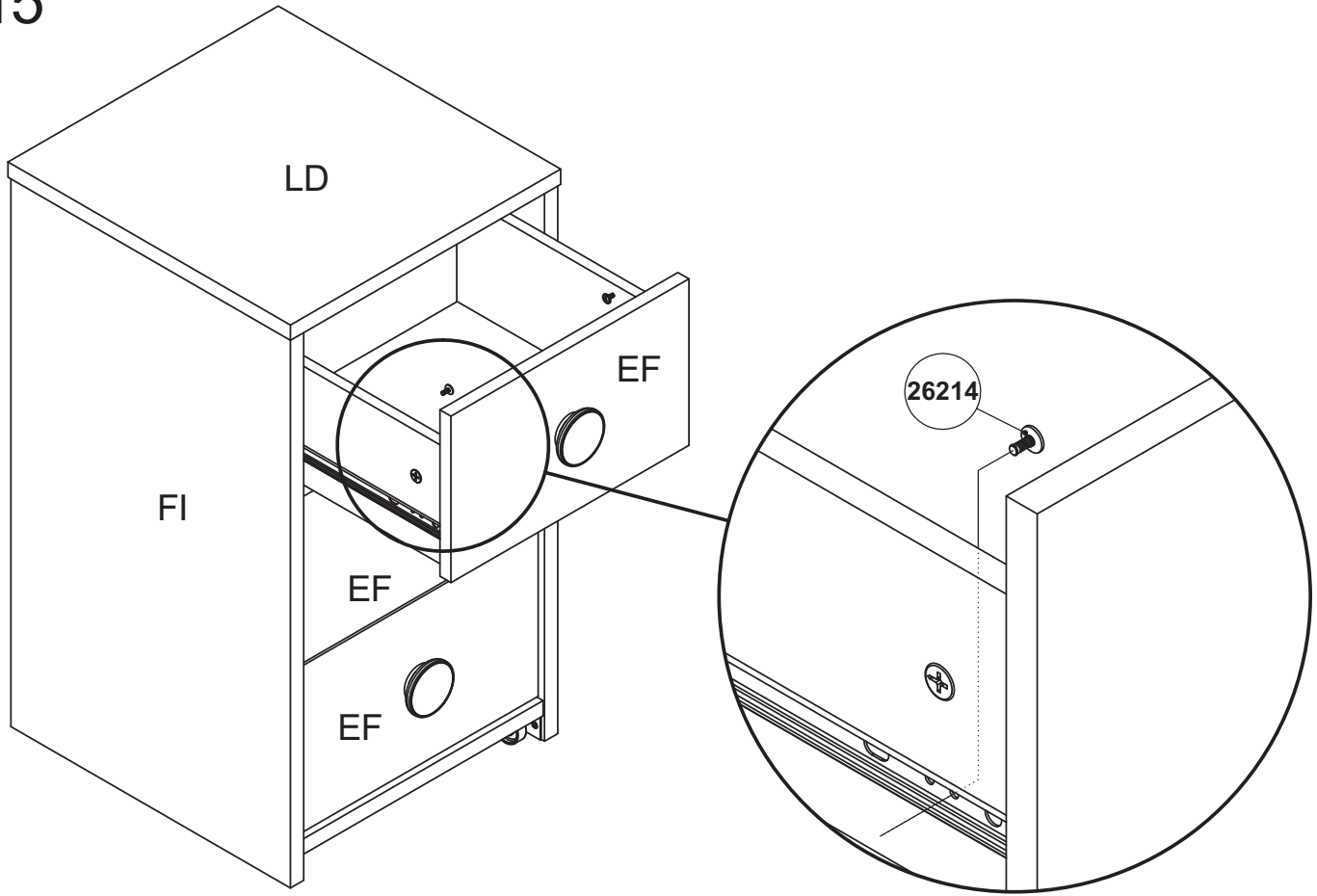

16

